

Plotted By: Aponte, Alan Sheet Set: Cypress Landing Condominium Parking Lot Layout: C5.00 - CPTD PLAN March 04, 2025 10:12:12am K:\FTL_Civil\044-Jobs\044203010-Cypress Nook\CAD\PlanSheets - Cypress Nook\C5.00 - CPTD PLAN.dwg This document, together with the concepts and designs presented herein, as an instrument of service, is intended only for the specific purpose and client for which it was prepared. Reuse of and improper reliance on this document without written authorization and adaptation by Kimley-Horn and Associates, Inc. shall be without liability to Kimley-Horn and Associates, Inc.

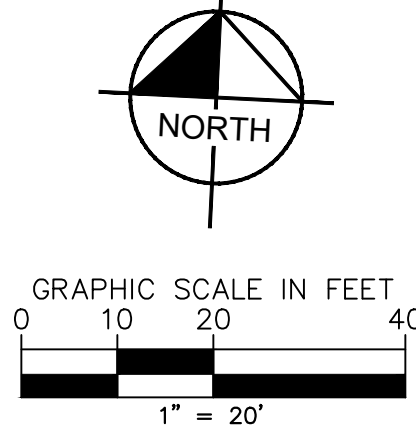
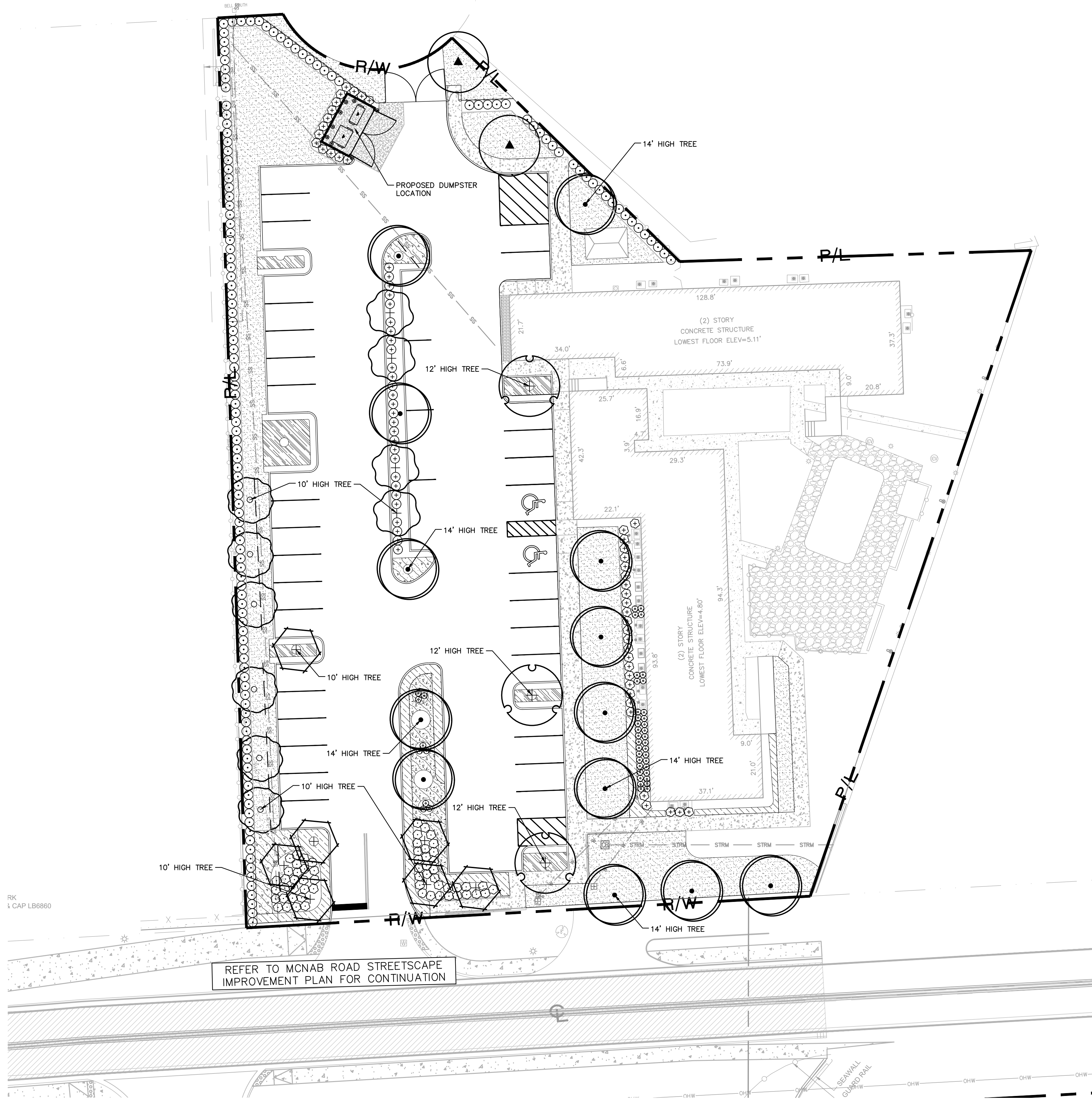

LEGEND

- CL CENTER LINE OF ROADWAY
- R/W P/L RIGHT-OF-WAY OR PROPERTY LINE
- EXIST BUILDING

NOTES:

- EACH AND ALL OF THE CPTD SECURITY STRENGTHENING NARRATIVE PLAN CONDITIONS ARE PART OF AND INTEGRAL TO THE APPROVED DEVELOPMENT PLANS AND MUST BE COMPLETED FOR PROJECT APPROVAL.

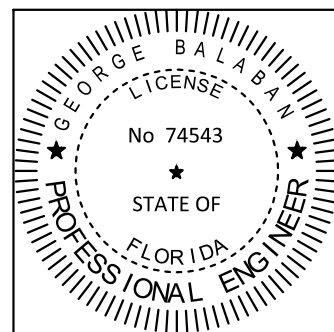

THE ITEM HAS BEEN DIGITALLY SIGNED AND SEALED BY GEORGE BALABAN ON THE DATE ADJACENT TO THE SEAL.

PRINTED COPIES OF THIS DOCUMENT ARE NOT CONSIDERED SIGNED AND SEALED AND THE SIGNATURE MUST BE VERIFIED ON ANY ELECTRONIC COPIES.

PLANS ARE IN NAVD 1988 DATUM
CONVERSION EQUATION IS BELOW:
(NAVD 1988) + 1.58' = (NGVD 1929)

THE PRESENCE OF GROUNDWATER SHOULD BE ANTICIPATED. CONTRACTOR'S BID SHALL INCLUDE CONSIDERATION FOR ADDRESSING THIS ISSUE AND OBTAINING ALL NECESSARY PERMITS.

Always call 811 two full business days before you start to have underground utilities located and marked.

Sunshine 811.com

P#25-12000006

CYPRESS LANDING CONDOMINIUM PARKING LOT PREPARED FOR CITY OF POMPAHO BEACH POMPAHO BEACH, FL		CPTD PLAN		KHA PROJECT 044203010 DATE FEB 2025 SCALE AS SHOWN DESIGNED BY TVC DRAWN BY TVC CHECKED BY GB		LICENSED PROFESSIONAL THOMAS C. HARGRETT, PLA FL LICENSE NUMBER LA #6667512 DATE: 02/12/2025		Kimley»Horn © 2025 KIMLEY-HORN AND ASSOCIATES, INC. 8201 PETERS ROAD, SUITE 2200, PLANTATION, FL 33324 PHONE: 954-535-5100 FAX: 954-739-2247 WWW.KIMLEY-HORN.COM REGISTRY No. 35106			
SHEET NUMBER C5.00											